

## Development of a Local Disaster Prevention Base

With the cooperation of primary schools, parks and community welfare centers, we form bases for disaster prevention that cover a neighborhood based on a primary school block. We assist regional activities implemented mainly by citizens and voluntary activities for disaster prevention.

### [Outline of the Plan]

- 1) Making joint use of schools and parks
  - Abolishing mutual borders and making joint use of them, mostly as bases of regional activities and places for environmental education.
  - Forming cores in communities maintained voluntarily by citizens through opening of schools to neighborhoods.
- 2) Strengthening functions of disaster prevention
  - Strengthening resistance of buildings against earthquakes and fires; developing tree-lined roads that provide safe ways for shelter.
  - Strengthening capabilities to provide information for citizens (wireless radios for disaster prevention, mini-FM car).
- 3) Developing "life spots" (bases to give assistance for attaining a minimum level of independent life when utility facilities such as for water, electricity and gas supplies stop functioning).
  - Preparing drinking water, water for living and fire fighting
  - Preparing energy sources in cases of emergency by introducing solar-power generation and generators.
  - Storing items for emergency such as equipment for fire fighting

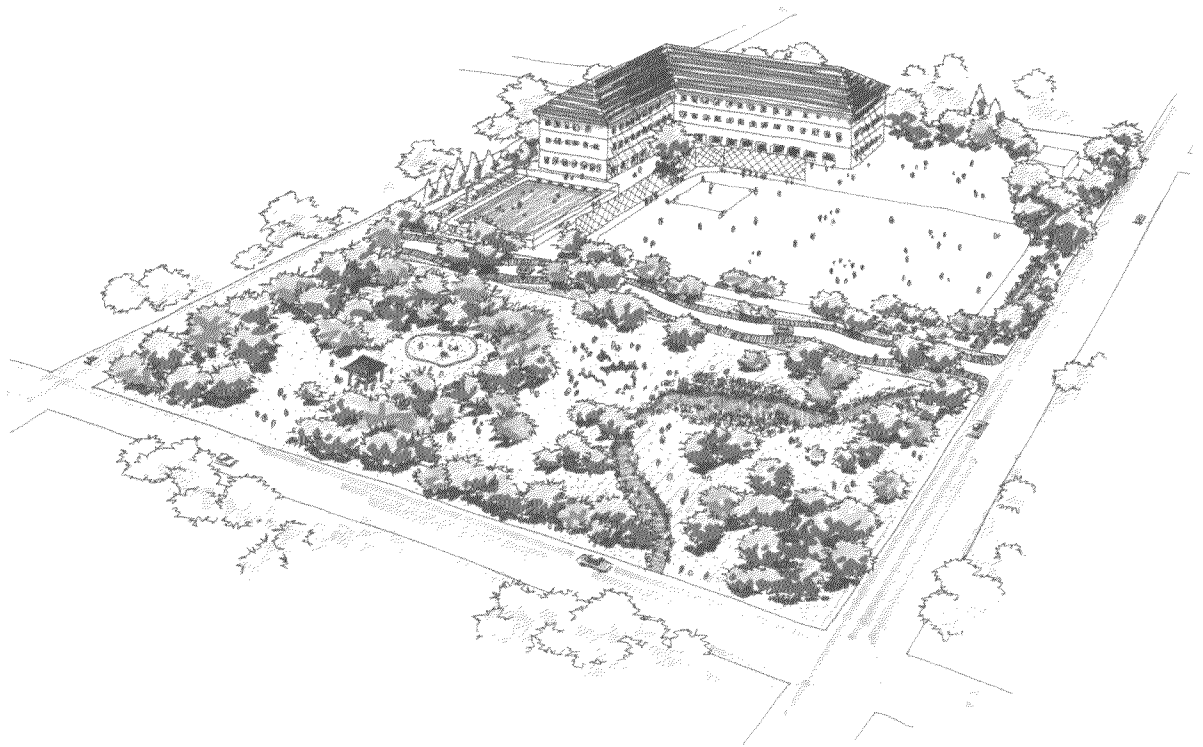

## Creation of a City with Water and Greenery

We will proceed with creating spaces that have a lot of water and greenery daily as places where people feel close to nature, and take shelter or have water for living and fire fighting in cases of emergency.

### [Outline of the Plan]

#### 1) Creating Network of Water and Greenery

- Developing green zones in which people enjoy daily contact with nature and creatures. The zones prevent fires from expanding and provide ways or places for shelter when disasters break out. (Planting greenery along rivers, roads in downtown areas, mountain and coastal areas.)
- Creating environments for promenades jointly using buildings and roads in accordance with city creation.
- Keeping the amount of water in rivers in downtown areas stable by an extensive connection of rivers.

#### 2) Contact with the sea

- Developing a shoreline that has white sand and pine trees along the seashore of Suma and Maiko, establishing the Marinepia Kobe as a base.
- Making spaces in Kobe Port where people feel close to water; making use of water and securing spaces for shelter in cases of emergency.

#### 3) Creating water and greenery as regional symbols

- Securing green zones and planting hedges, forming towns with a lot of greenery by planting greenery on roofs and along walls.
- Utilizing well water and rain water as symbols of regions.
- Creating rich water environments, such as streams and artificial ponds, using water to treat sewage.

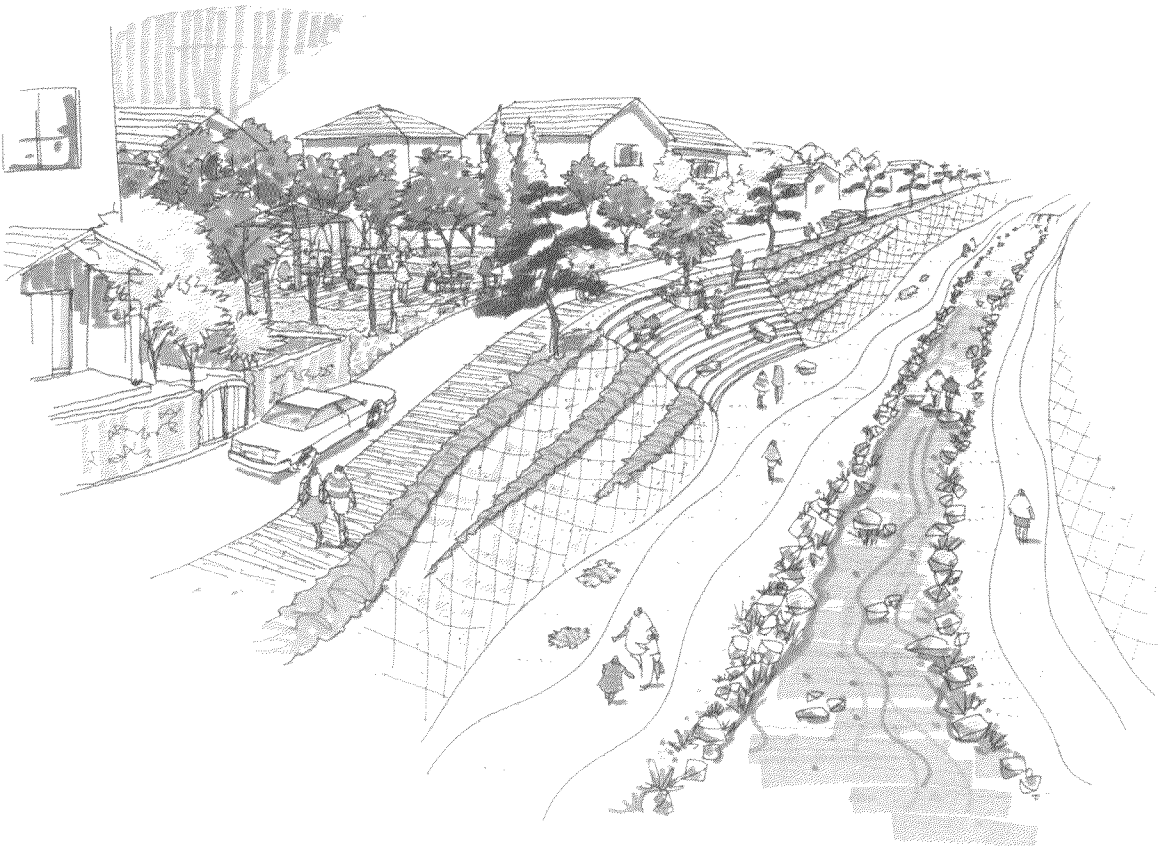

## Development of a City Center Symbolic Zone Connected to the Sea

A zone with Sannomiya Station as its center, covering an area from Shin-Kobe Station to the metropolitan coastal area near the Shinko 4th Pier, is positioned as a symbolic zone to appeal for the restoration of Kobe as an international port city. Bases for disaster prevention and parks and green zones to commemorate the recovery from disasters are developed. New city environments, which are comfortable, disaster-resistant and attractive, are created.

### [Outline of the Plan]

- 1) Areas to be covered Shin-Kobe Station - JR Sannomiya Station - City Hall - Higashi Yuenchi Park - Shinko 4th Pier
- 2) Major projects in the plan
  - Developing centers of disaster prevention in areas near City Hall and Kyobashi.
  - Expansion and development of the Higashi Yuenchi Park
  - Developing attractive sidewalks extending from Flower Road to the coastal areas
  - Building terminals for passengers and green zones around Shinko 1st and 4th Piers.
  - Utilizing historical buildings such as the Kobe Customs Office.
  - Redevelopment of the square in front of Sannomiya Station.
  - Unified restoration of neighboring areas by utilizing a District Planning System.
  - Encouraging improvement of landscape by utilizing such systems as an Appointment System for Improvement of Landscape
  - Construction of solid networks for pedestrians by using decks and facilities on and under the ground.
  - Establishment of a monument by inviting international ideas.

### Development of a City Center Symbolic Zone Connected to the Sea

