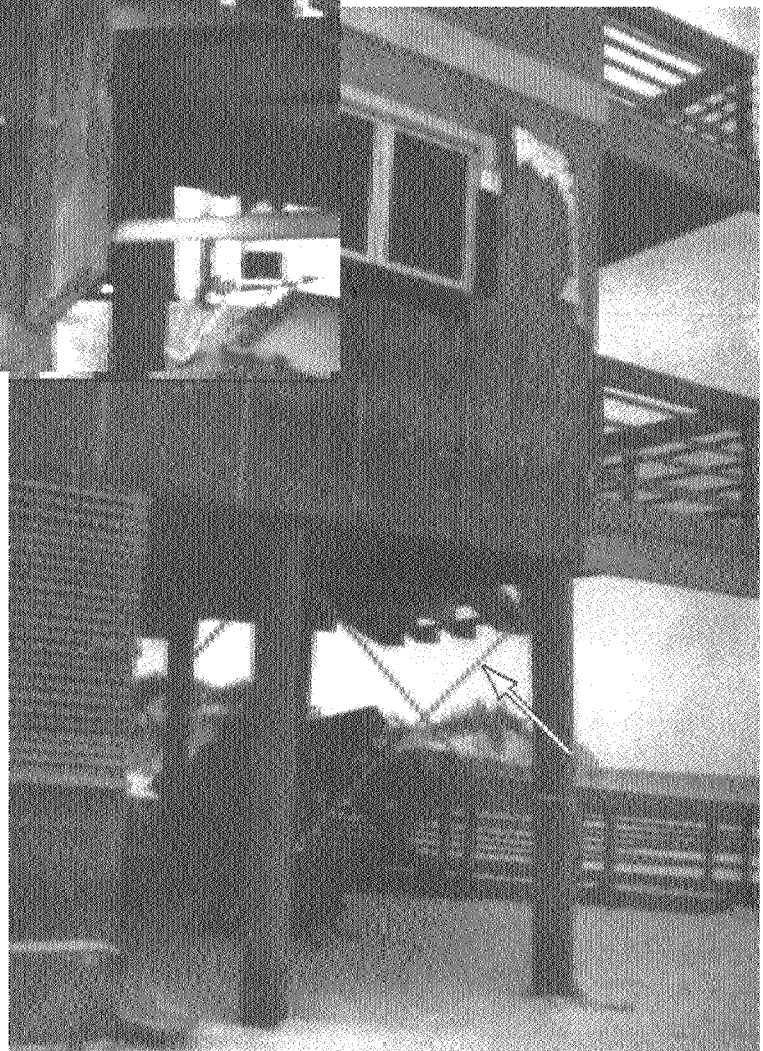

*Figure 2-9*

*The floor beam connection and beam support shown here illustrate the lack of design and proper construction observed on many damaged structures. Note the bolt pullouts (circled). Also, the beam support is attached to the pile with lag bolts rather than bolts that extend through the pile.*



*Figure 2-10*

*This undamaged threaded rod & turnbuckle (arrow) cross-bracing continues to provide additional support as designed.*