

Fig. 7.22 Face of concrete block removed to expose ungrouted reinforcing steel, shear wall in Anacapa Residence Hall.



Fig. 7.23 Another example of ungrouted reinforcing steel, shear wall in Anacapa Residence Hall.

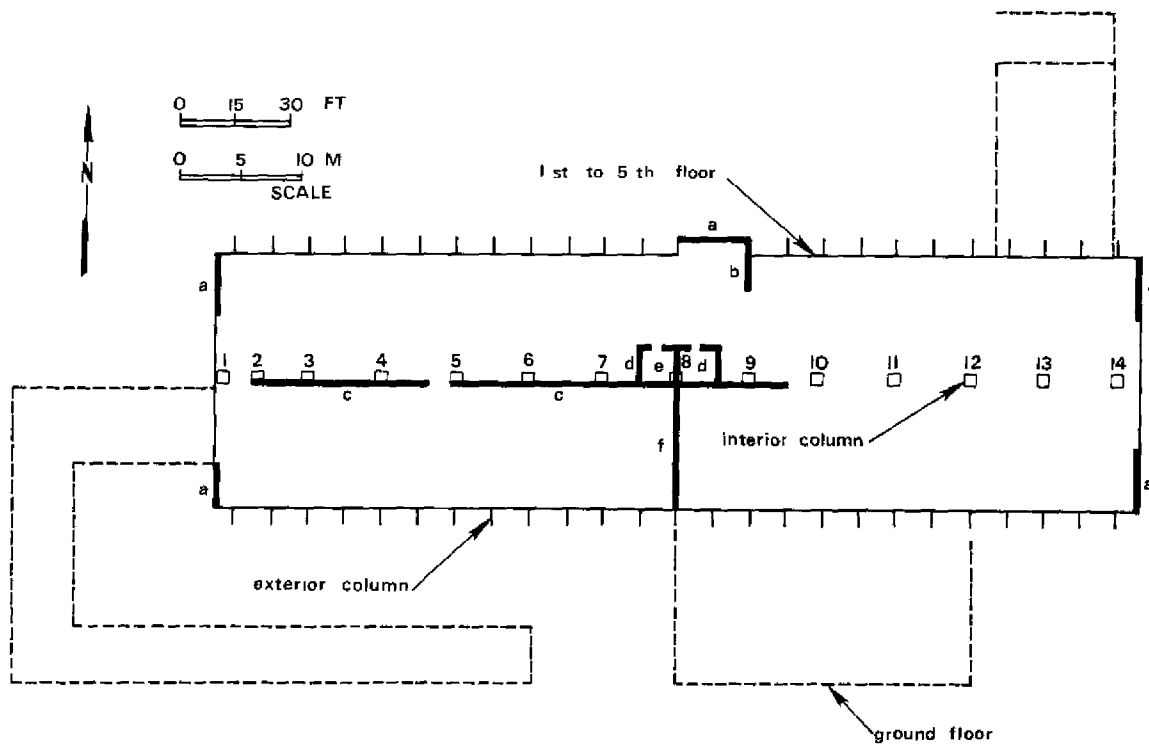

Fig. 7.24 Floor plan of Engineering Building, UCSB.

TABLE 7.3

DETAILS OF REINFORCEMENT IN SHEAR WALLS, ENGINEERING BUILDING, UCSB

Wall (Fig. 7.24)	Specified Reinforcement
a	12 inch reinforced concrete wall vertical: #4 bars at 24 inches each face, staggered horizontal: #7 bars at 1/3 story height each face
b	10 inch reinforced concrete wall vertical: #4 bars at 16 inches each face horizontal: #4 bars at 16 inches each face
c	8 inch reinforced concrete wall vertical: #4 bars at 16 inches on centers horizontal: #4 bars at 10 inches on centers
d	8 inch reinforced concrete wall vertical: #3 bars at 18 inches on centers, each face horizontal: #3 bars at 11 inches on centers, each face
e	10 inch reinforced concrete wall vertical: #3 bars at 16 inches on centers, each face horizontal: #4 bars at 16 inches on centers, each face
f	10 inch reinforced concrete wall vertical: #3 bars at 16 inches on centers, each face horizontal: #4 bars at 16 inches on centers, each face